

PAD-BIO

OPERATION AND INSTALLATION MANUAL



Version 1 01/01/25
Contents of manual may be updated without notice. For
the latest version of this manual please refer to our
website: www.paulagnewdesigns.com.au

PAUL AGNEW

DESIGNS



1. **WARNING!**

Before any use, the device must be installed accordingly to paragraph 3&4.

This apparatus is manufactured to have intermittent functioning.

Ignoring these instructions could result in death or injury.

Use your device only in well ventilated areas.

Always observe the rules for provision of combustion and ventilating air for unvented heaters.

Installing the fireplace horizontally (check it with a spirit level). Fix it strongly against the wall or on the ground.

Respect the local and national laws regarding the use of fireplaces.



SAFETY ADVICE!

- Every room where the apparatus is used must be provided with a sufficient fresh supply of oxygen (accordingly to the local rules and regulation).
- Do not use the device near flammable objects.
- Never use your device to heat or boil water or as a cooking appliance.
- It is forbidden to use this device in caravans on the systems of safety.
- A safety system prevents the ignition when the apparatus is hot. Do not hinder it's functioning.
- Do not move the device when it is running or cooling down.
- If the power cable supplied with the fire is damaged, please contact your supplier for a replacement from the manufacture.
- Never put your hand, touch or lean on the fireplace when it is functioning or during cooling period.
- It is advisable to have a powder or CO2 extinguisher near your fireplace in case of emergencies.
- Before igniting the fireplace you must be in the same room as the fireplace. Keep the fireplace permanently under surveillance as soon as the fire has started. Keep children away.
- Never use accessories which are not of origin of stamped by the manufacture.
- Never leave any objects on the device. Remove these objects before the ignition.
- Never use in a room with drafts.



COMBUSTIBLE WARNING!

- Only use denatured Ethanol (Ethyl-Alcohol) 95% vol. minimum.

PAD-BIO

- Never use other fuel or combustible.
- Never store the fuel for the device in your living areas.
- The addition of other additive (essential oil, perfumes) in the fuel is forbidden.
- Do not throw anything in the fuel which burns.

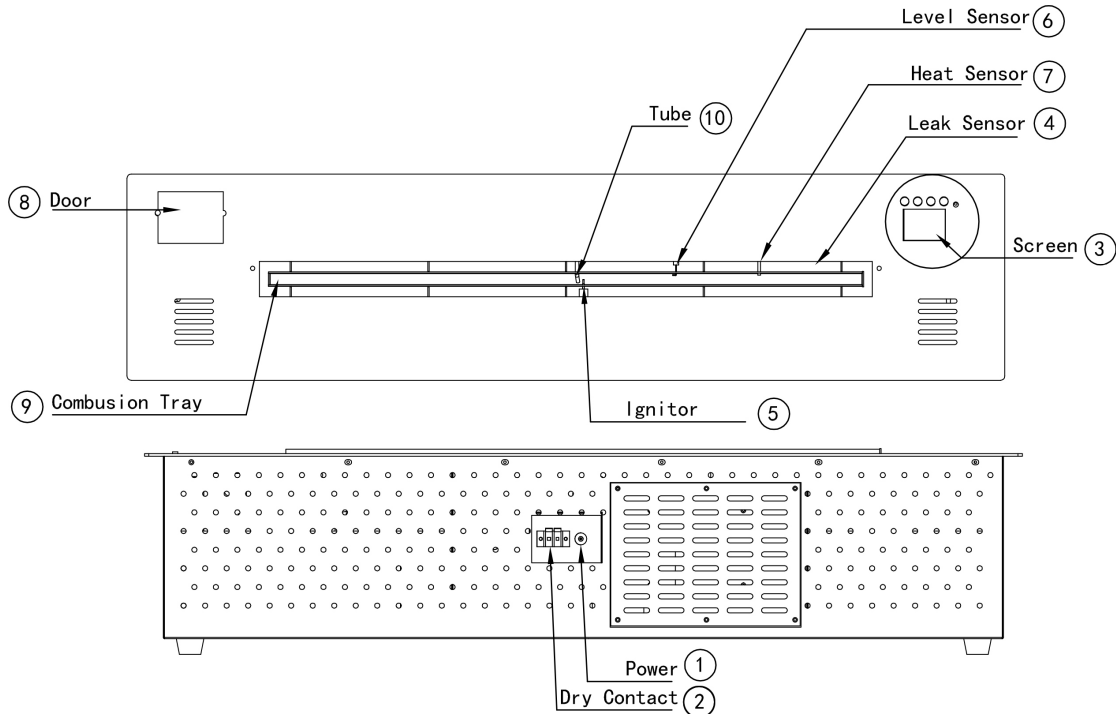

- During the filling, ventilate the room, do not smoke and switch on/off the mobile phone.
- The filling of the tank has to be made when the fire is put out (safety against the fire). An electronic security system prevents the tank door from opening by locking it while the burner is running or is still in high temperature. When the burner is cold, you can press on the trap door switch for refueling.
- Never dispose the fuel in the water pipelines nor in nature. Respect the environment.

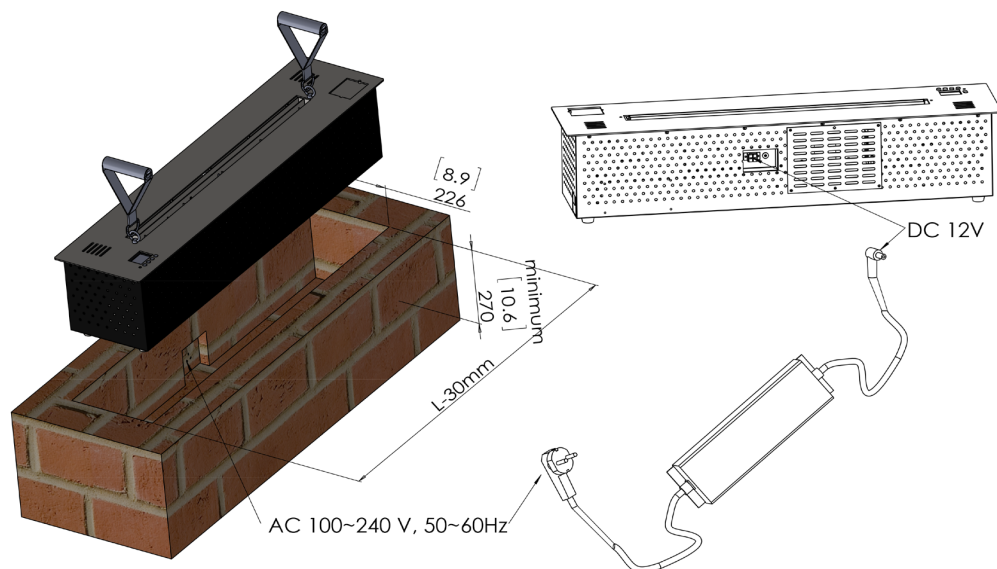

- Do not store bio-ethanol near the fireplace.

2. TECHNICAL CHARACTERISTICS OF THE DEVICES

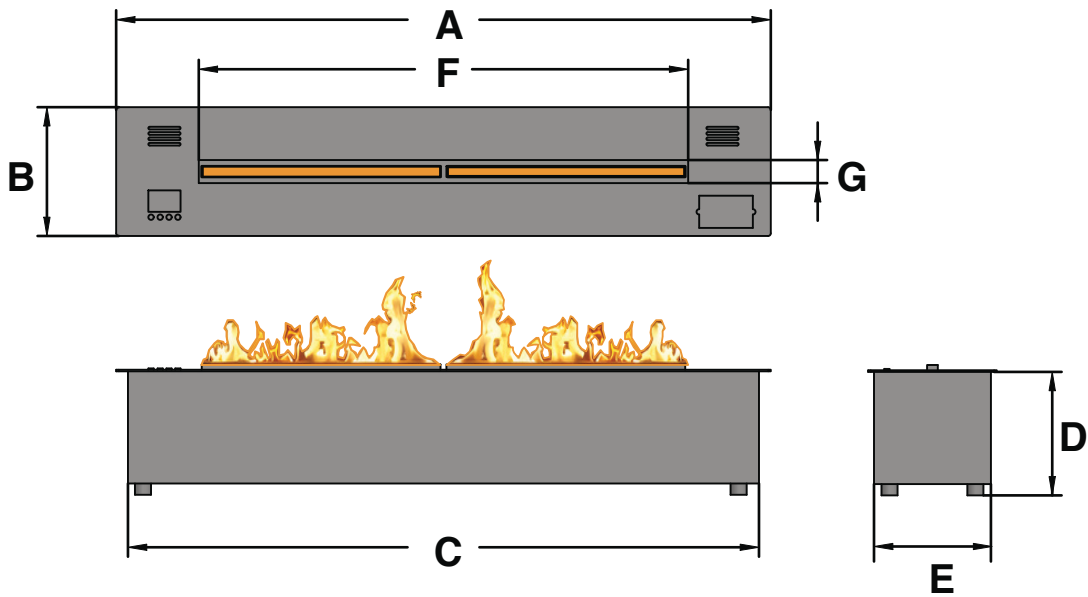

MODEL	A	B	C	D	E	F	G	WEIGHT (KG)
PAD-B-50	500	240	476	230	216	334	47	18
PAD-B-66	680	240	636	230	218	434	41	22
PAD-B-80	820	240	776	230	218	512	41	27
PAD-B-100	1020	240	976	230	218	712	41	29
PAD-B-110	1120	240	1076	230	218	812	41	33
PAD-B-120	1220	240	1176	230	218	912	43	36
PAD-B-130	1320	240	1276	230	218	1012	43	40
PAD-B-140	1420	240	1376	230	218	1112	43	44
PAD-B-150	1520	240	1476	230	218	1212	43	48
PAD-B-180	1820	240	1776	230	218	1512	43	58
PAD-B-210	2100	240	1976	230	218	1712	43	68
PAD-B-250	2500	240	2376	230	218	2112	43	78

HOUSING DIMENSIONS

The minimum housing cavity opening requirements

CW - C + 10mm

CH - D + 15mm

CD - E + 10mm

*CW - Cavity Width; CH - Cavity Height; CD - Cavity Depth

All dimensions are given in mm

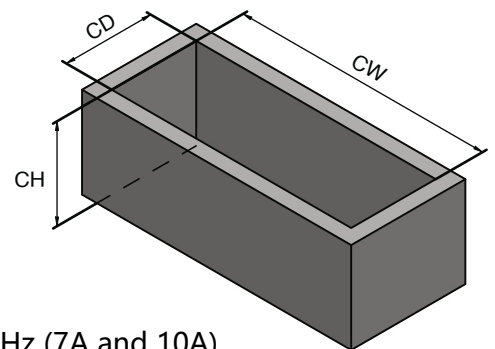

Device equipped with an adapter 12 volts-110/240 V AC 50-60 Hz (7A and 10A).

Device equipped with an infrared remote control (Batteries not supplied). Never start an device which will be unattended afterwards.

3. PREPARATION OF THE DEVICE BEFORE USE

Remove the packaging of your device.

Verify that there is no object in the burner. Remove it if necessary.

Devices MUST BE mounted on the wall, fixed on the ground or built-in.

● Fireplaces installation

A mounting bar with holes is supplied with wall fireplaces

Use a spirit level to ensure that the bar is straight; fix it by using appropriate screws according to

the type of chosen wall.

With the help of another person, hang the fireplace in position.

Check that the fireplace has a right level by using a spirit level.

For floor mounted devices, fix it to the floor with screws. (4 holes in the bottom of the device).

● Burners Installation

Build-in the burners according to the flame level.

Check that the fireplace has a right level by using a spirit level.

4. SPECIAL PRECAUTIONS FOR INSTALLATION

- Do not cover the device.
- Do not put objects on the device when functioning.
- Leave a free access to the control buttons.
- Do not leave curtains or lace curtains within 1 meter of the device.
- Do not use in a room with draught.
- Warn people around you, particularly children of the dangers of fire. Never let them approach the device.

5. POWER SUPPLY CONNECTION

An adapter is provided with your device: INPUT 100-240 volts 50/60 Hz and OUTPUT 12V/7A or 12V/10A.

Before positioning, the device must be connected with the supplied adapter to the power supply.

6.FILLING OF THE TANK

(1) To open the door of the tank, press on the button  near the LED screen.

Or Press the Remote Controller  Button and open the door immediately.

(2) Use Funnel to Fill 95% bio ethanol into the tank of the burner from white plastic lid.

Or Keep pressing button "IN" three seconds, the ethanol will be pumped into the burner automatically.

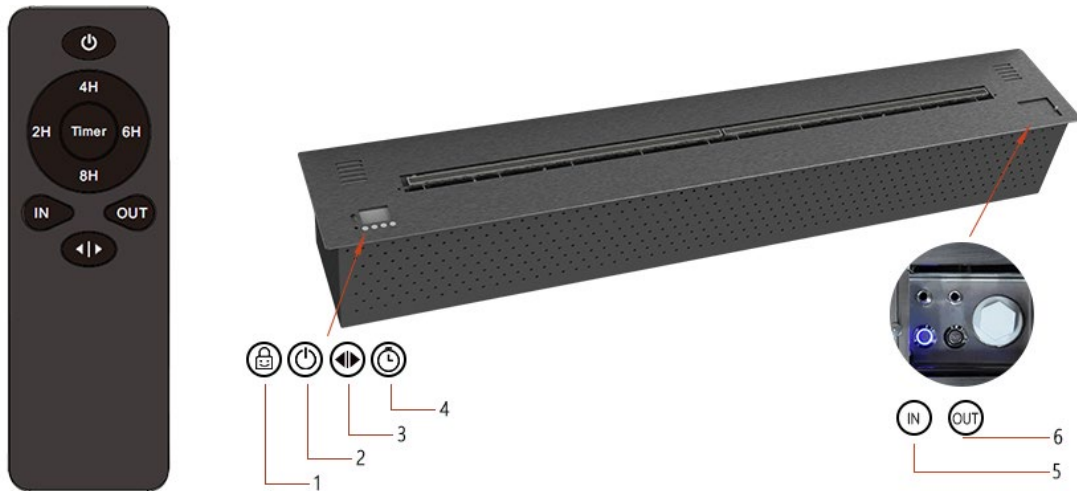

Notice:

- NEVER fill the burner directly. ALWAYS fill the tank from the tank door..
- Use only the recommended fuel minimum 95% delivered in a packaging of safety.
- Fill the tank carefully without overflowing. Do not smoke, switch on/off the mobile phone near the fireplace.
- If the burner is too hot, the door will not open (Error message:TEMP/HEAT). wait until the temperature decrease.
- Close the bottle and store it away far from the fireplace.
- Stop the filling once the maximum level is reached: a BIP is emitted by the electronic gauge.
- If ever some ethanol spills out the reservoir, wipe it completely with a cloth or an absorbing paper before starting the fireplace.
- Check that no ethanol trace remains outside of the tank door before ignition.

You absolutely need to close the tank trap door if you want to ignite your ethanol fireplace.

For security reasons a system will check and lock the trap door before ignition.

It is recommended to full the tank for the first use!

7. INSTRUCTION OF USE

a) Buttons and LED Screen

Button 1: Child Lock Button

Button 2: ON/OFF Button

Button 3: Tank door Button

Button 4: Timer Button

Screen: LED Screen

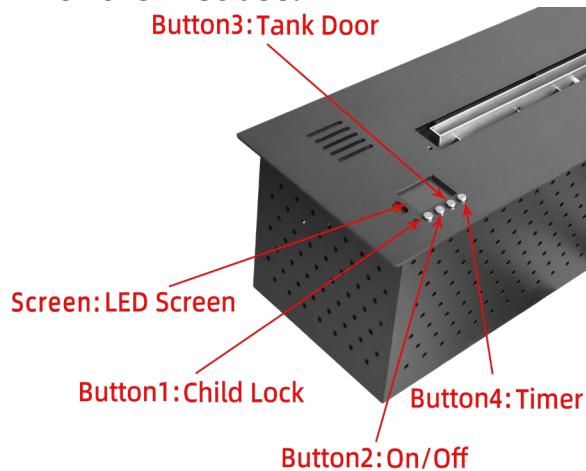

b) Ignition

Ignite and shut the device only with the switch ON/OFF Button or the remote control or "Dry Contact" .

Leave a remote control out reach of Children.

Press the Button **ON/OFF on the Unit For FIVE SECONDS** or press on the remote control, the pump will automatically fill up the fireplace. After a few seconds an automatic ignition will take place. If the first ignition is failed, there will be a second one. If the fireplace failed to be lit up, please consult the "Error Message" on the LED screen and read the paragraph "Error Message".

Never directly fill up the burner tray.

c) Shutting

Shut down the device with the switch ON/OFF on the unit or press on the remote control only, The pump will stop. Wait for the flame to stop completely before leaving the room..

For security reasons, it is not possible to relit the device just after its extinction. The temperature of the fireplace must have cooled down under 60°C:140°F before restarting. Please wait a few minutes.

8.ERRORS AND FUNCTIONING MESSAGE

Message	Anomaly and functions	Solutions
LACK OF FUEL	The tank is empty	Fill the tank with fuel
Tank is Full Close the	The tank is full	Stop filling and close the door

PAD-BIO

door		
FILL WITH FUEL	Filling the tank	Keep Filling the tank
TEMP Is High, Please Wait!	The temperature of the fireplace is over 60°C-140°C F	Wait until the temperature decrease
DOOR Is Opened	The tank door is not closed well	Close the trap door of the tank
FAIL Failure Of Ignition	Failure of the ignition	Try again or light ethanol by hand while igniter turns red.
HEAT Is High, Please Wait!	Combustion tray is burning, the other not, The temperature of the burner is over 60°C	Try again until burner temperature decrease. After 3 attempts contact your retailer
PUMP	Pumping	Check that pump working or not. If not, contact your retailer.
LEAK	The ethanol over flow from the combustion tray into the safety tray	Check that there is no flame inside the safety tray. If yes contact your supplier.
SHAK	The burner is shaken by external forces.	Stop the burner and restart the burner again
CO2	The CO2 concentration in the room is high level	Let fresh air in the room space.

WARNING: Your device works with automatic positive safeties, If an error message appears, you can restart the device only if the error has been corrected.

9.REMOTE CONTROLLER



- 2 x AAA Battery



**Attention: 3V Remote Controller
Needs 2 piece 1.5V #7 battery inside.**

10.MAINTENANCE AND CLEANING

- All the operations of cleaning and maintenance must be done with a dead fire and cold device.
- Clean the burners with a soft rag or cloth.
- Some components are determining the safety and the functioning of your device.

Their replacement may modify the performances of your device. Only original components must be used during the operations of maintenance, or reparations. This maintenance must only be operated by specialists.

Failure to observe this operating manual and its operating instructions as well as unauthorized tampering with the device releases us from any liability and also invalidates the warranty covering the devices and accessories.

PAD-BIO

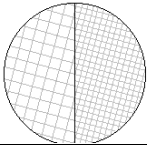

EN NON-FLAMMABLE MATERIAL
DE NICHT BRENNBARE MATERIALIEN
FR MATÉRIAU NON INFLAMMABLE

ES MATERIAL NO INFLAMABLE
IT MATERIALE NON INFIAMMABILE
PL MATERIAŁ NIEPALNY
RU НЕВОСПЛАМЕНЯЮЩИЙСЯ МАТЕРИАЛ

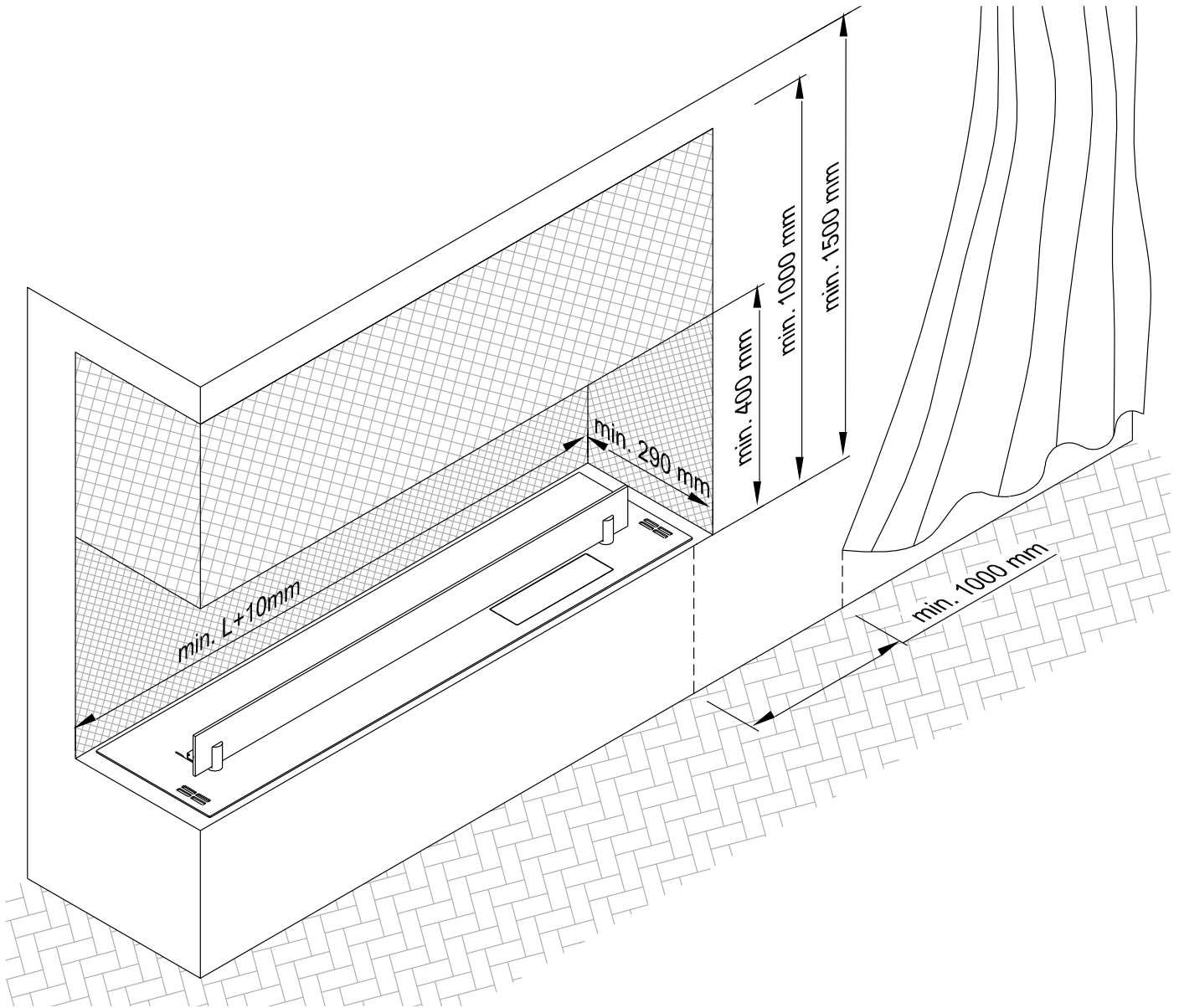

EN	The fireplace surrounding must be made of non-flammable materials and insulated from any flammable elements of the construction. Use only fasteners and adhesives that are resistant to high temperature.
DE	Das Gehäuse aus nicht brennbaren Materialien angefertigt, von allen brennbaren Elementen der Konstruktion isoliert.
ES	El encajamiento debe ser de materiales no combustibles, aislado de todos los elementos inflamables de la estructura. Los conexiones y aglutinantes deben ser resistentes a altas temperaturas.
FR	L'encastrement doit être de matériaux incombustibles, isolé de tous les éléments inflammables de la construction. Les raccordement et liants doivent être résistants aux hautes températures.
IT	La struttura ad incasso deve essere fatta di materiali non combustibili, isolati da tutti gli elementi infiammabili della struttura. Collegamenti e leganti devo essere resistenti alle alte temperature.
PL	Zabudowa wykonana z materiałów niepalnych, odizolowana od wszelkich palnych elementów konstrukcji. Łączenia i spoiwa odporne na działanie wysokich temperatur.
RU	Конструкция, в которой установлен камин должна быть изготовлена из невоспламеняющихся материалов, и она должна быть изолированной от любых воспламеняющихся элементов. В качестве соединений, адгезивных веществ используйте термостойкие продукты.

EN Selected installation options / **DE** Montagemöglichkeiten / **FR** Options de montage sélectionnées / **ES** Opcі montaje seleccionadas / **IT** Selezionate opzioni di montaggio / **PL** Wybrane możliwości montaży / **RU** Варианты размещения

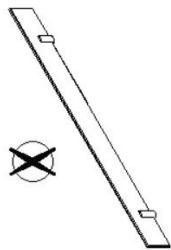

EN GLASS SHIELD (B)
DE TECHNISCHES GLAS (B)
FR VITR TECHNIQUE (B)
ES VIDRIO PROTECTOR (B)
IT VETRO PROTETTIVO (B)
PL SZYBKA TECHNICZNA (B)
RU ТЕХНИЧЕСКОЕ СТЕКЛО (B)

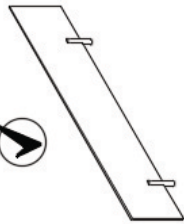

EN OPTIONAL TEMPERED GLASS PANEL
DE GLASPANEL
FR PANNEAU EN VERRE
ES PANEL DE VIDRIO
IT PANNELLO DI VETRO
PL PANEL SZKLANY
RU СТЕКЛЯНАЯ ПАНЕЛЬ

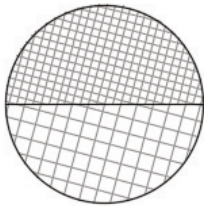

EN NON-FLAMMABLE MATERIAL
DE NICHT BRENNBARE MATERIALIEN
FR MATÉRIAU NON INFLAMMABLE
ES MATERIAL NO INFLAMABLE
IT MATERIALE NON INFIAMMABILE
PL MATERIAŁ NIEPALNY
RU НЕВОСПЛАМЕНЯЮЩИЙСЯ МАТЕРИАЛ

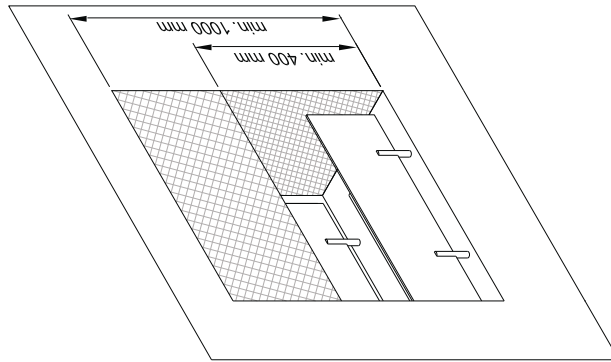
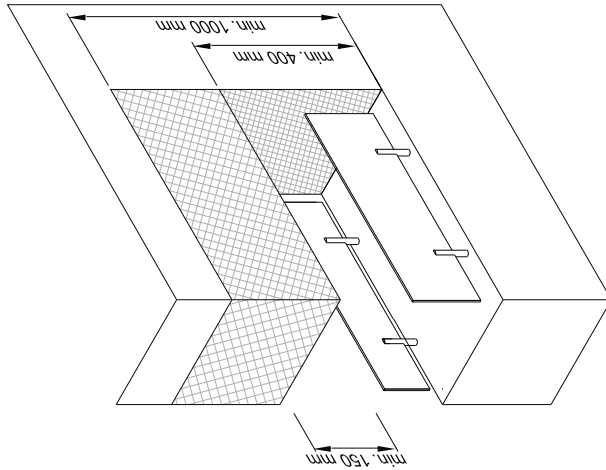
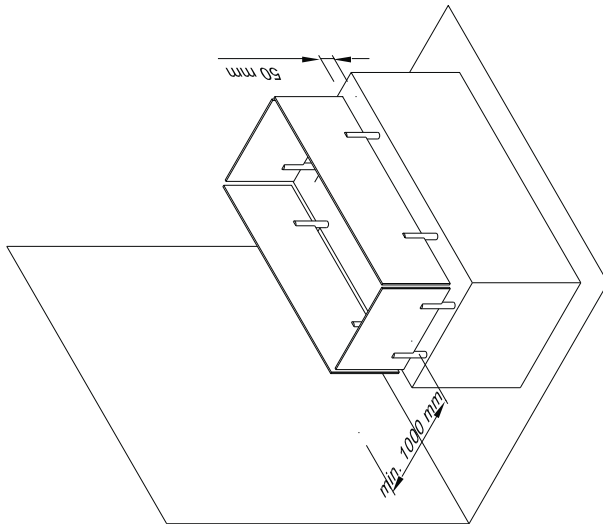

TV

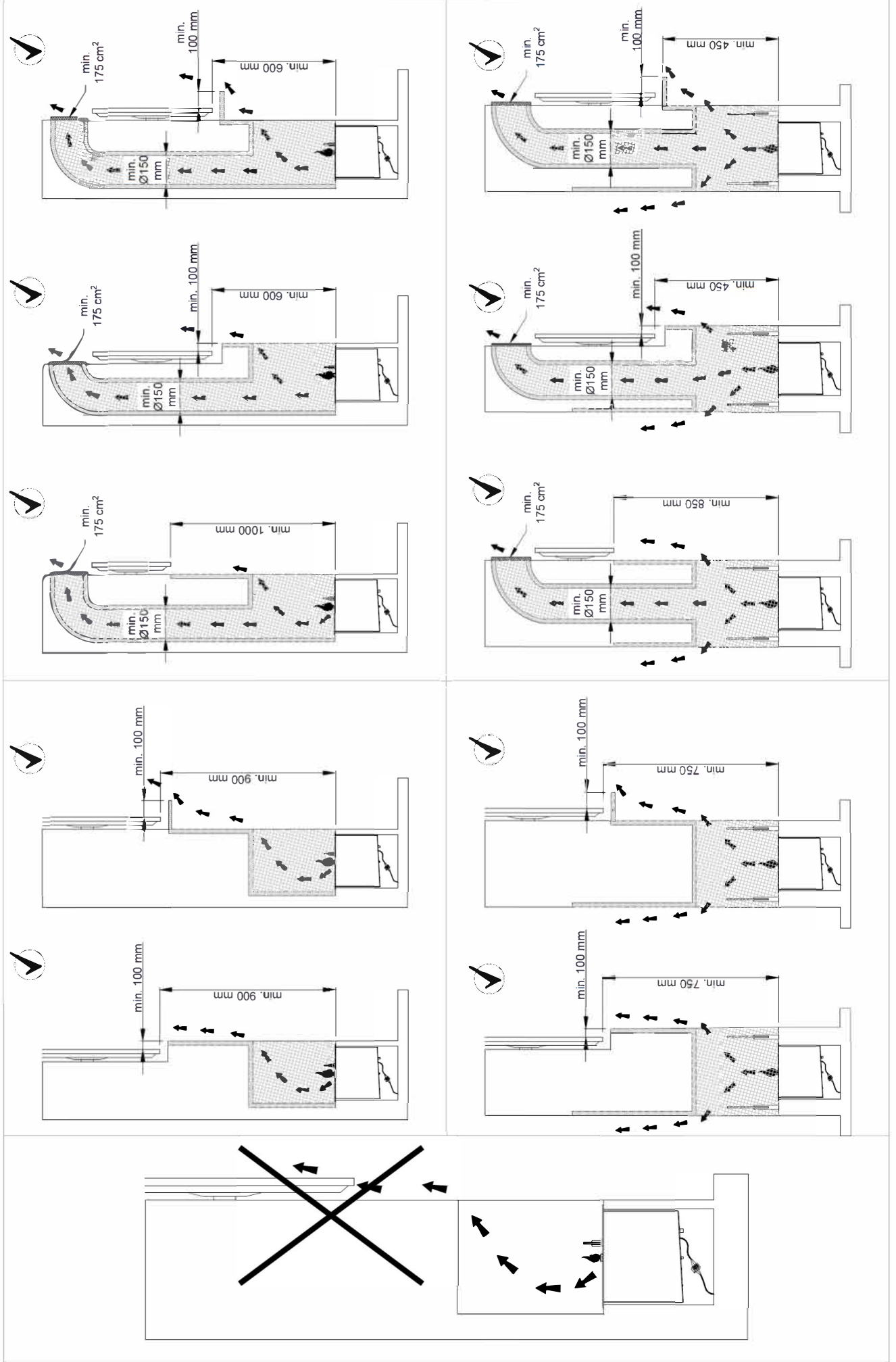

11.COLORS OF THE PANEL AVAILABLE

Mirror Black

Brush Black

Stainless Steel

Brushed Gold

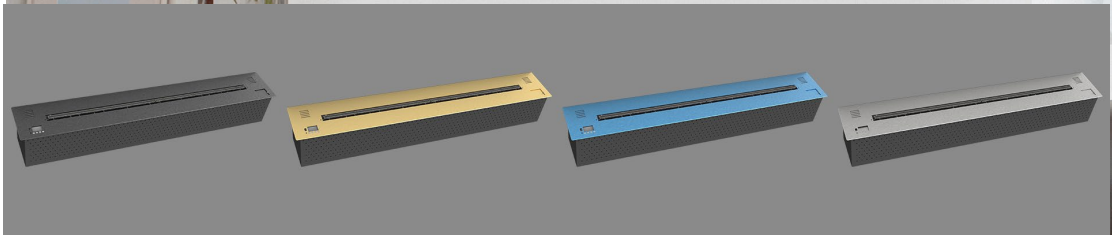

PAUL AGNEW

DESIGNS

148 Cochranes Road
Moorabbin, Victoria 3189
www.paulagnewdesigns.com.au
info@paulagnewdesigns.com.au